

# FRAME AND MOUNTING

## GROUP 02

(6000)

### SECTION 02-03 Engine and Transaxle Mounting

SUBJECT	PAGE	SUBJECT	PAGE
<b>REMOVAL AND INSTALLATION</b>		<b>SPECIAL SERVICE TOOLS</b> .....	<b>02-03-4</b>
Engine Mount, Front .....	02-03-2	<b>SPECIFICATIONS</b> .....	<b>02-03-4</b>
Engine Mount, Rear .....	02-03-2	<b>VEHICLE APPLICATION</b> .....	<b>02-03-1</b>
Engine Mount, RH .....	02-03-1		

#### VEHICLE APPLICATION

Capri.

#### REMOVAL AND INSTALLATION

##### Engine Mount, RH

##### Removal

1. Support engine assembly with floor jack.
2. Remove mount to engine bracket retaining nuts.
3. Remove through bolt.
4. Remove bracket-to-body retaining bolts.

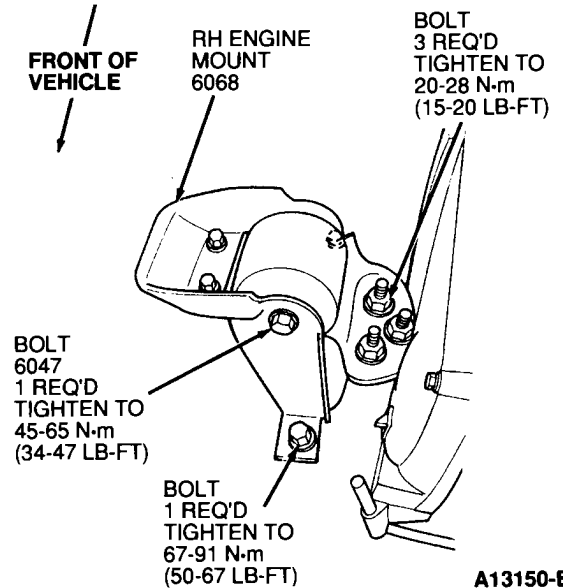

**REMOVAL AND INSTALLATION (Continued)****Installation**

1. Position bracket to body. Tighten smaller bolts to 20-28 N·m (15-20 lb-ft). Tighten larger bolt to 67-91 N·m (50-67 lb-ft).
2. Install engine mount to engine bracket. Tighten nuts to 60-85 N·m (45-62 lb-ft).
3. Install through bolt. Tighten to 45-65 N·m (34-47 lb-ft).
4. Remove floor jack.

**Engine Mount, Front****Removal**

1. Support engine with Three Bar Engine Support D88L-6000-A or equivalent.
2. Raise vehicle. Refer to Section 00-02.
3. Remove engine mount retaining nuts from crossmember.
4. Remove engine mount retaining bolts from transaxle.
5. Remove through bolt, if required.

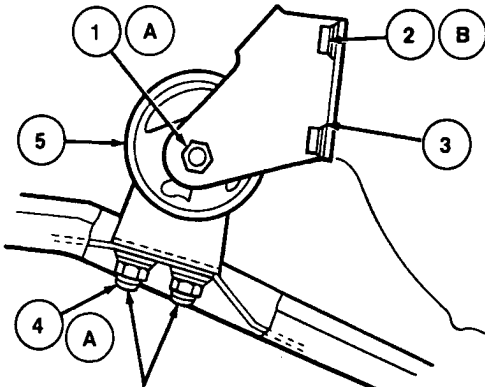

APPLY TWO DROPS OF THREADLOCK 262 E2FZ-19554-B (ESE-M4G204-A3) OR EQUIVALENT.

A13151-B

Item	Part Number	Description
1A	—	Nut and Bolt Assy
2B	—	Bolt (4 Req'd)
3	6031	Front Engine Mount Bracket
4A	—	Nut (2 Req'd)
5	6038	Front Engine Mount
A		Tighten to 64-89 N·m (48-65 lb-ft)
B		Tighten to 37-52 N·m (28-38 lb-ft)

**Installation**

1. Position engine mount to transaxle. Install retaining bolts. Tighten to 37-52 N·m (28-38 lb-ft).
2. Apply two drops of Threadlock 262 EZ FZ-19554-B (ESE-M4G204-A3) or equivalent to studs and install engine mount to crossmember. Tighten retaining nuts to 64-89 N·m (48-65 lb-ft).
3. Install through bolt, if removed. Tighten to 64-89 N·m (48-65 lb-ft).
4. Lower vehicle.
5. Remove engine support.

**Engine Mount, Rear****Removal**

1. Support engine with Three Bar Engine Support D88L-6000-A or equivalent.
2. Raise vehicle. Refer to Section 00-02.
3. Remove front and rear engine mount to crossmember retaining nuts. Remove crossmember brace retaining bolts.
4. Remove LH A-arm retaining bolt. Remove engine support crossmember retaining nuts and bolts.

**REMOVAL AND INSTALLATION (Continued)**

5. Remove rear engine mount retaining bolts.

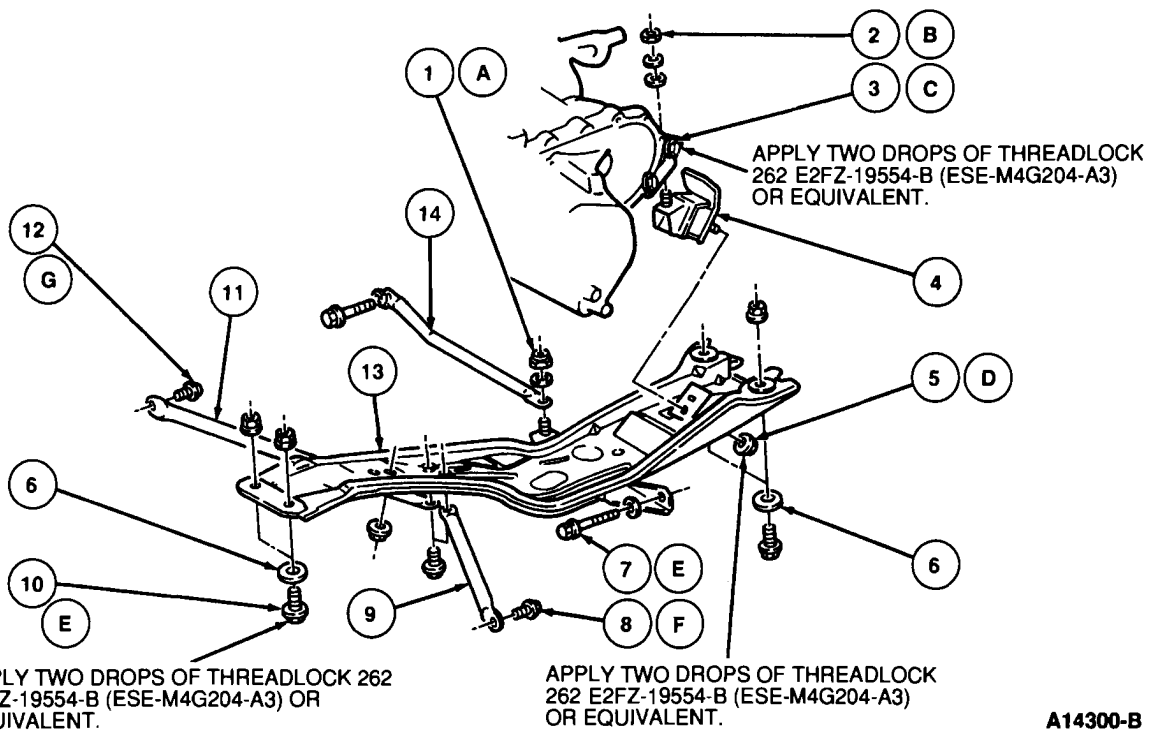

Item	Part Number	Description	Item	Part Number	Description
1A	—	Nut, Bolt and Washer Assy (1 Req'd)	12G	—	Bolt (2 Req'd)
2B	99921-1000	Nut (1 Req'd)	13	6A023	Crossmember Brace
3C	—	Bolt (2 Req'd)	14	3A339	Crossmember Brace
4	6068	Rear Engine Mount	A		Tighten to 35-50 N-m (26-36 lb-ft)
5D	8871-34222	Nut (1 Req'd)	B		Tighten to 38-46 N-m (29-33 lb-ft)
6	V830133-S36D	Flat Washer	C		Tighten to 50-61 N-m (37-44 lb-ft)
7E	6047	Bolt (2 Req'd)	D		Tighten to 32-47 N-m (24-34 lb-ft)
8F	—	Bolt (2 Req'd)	E		Tighten to 64-89 N-m (48-65 lb-ft)
9	6D028	Crossmember Brace	F		Tighten to 23-31 N-m (17-22 lb-ft)
10E	—	Bolt (4 Req'd)	G		Tighten to 28-46 N-m (21-33 lb-ft)
11	6D027	Crossmember Brace			

**Installation**

1. Install rear engine mount. Tighten retaining bolts to 37-52 N-m (28-38 lb-ft).

2. Install crossmember. Apply two drops of Threadlock 262 EZFZ-19554-B (ESE-M4G204-A3 or equivalent and tighten retaining bolts to 64-89 N-m (48-66 lb-ft). Tighten rear engine retaining nut to 64-89 N-m (48-66 lb-ft).
3. Install crossmember brace retaining bolts.

**REMOVAL AND INSTALLATION (Continued)**

4. Install LH A-arm retaining bolt. Tighten to 64-89 N·m (48-66 lb-ft).
5. Install front and rear engine mount to crossmember retaining nuts. Tighten to 64-89 N·m (48-66 lb-ft).
6. Lower vehicle.
7. Remove engine support.

**SPECIFICATIONS****TORQUE SPECIFICATIONS**

Description	N·m	Lb-Ft
Rear Engine Mount Upper Nut	38-46	29-33
Crossmember Brace (6D028) Bolts	23-31	17-22
Crossmember Brace (8D027) Bolts	28-46	21-33
Rear Engine Mount Bracket Bolts	50-61	37-44
Crossmember Brace Nut	35-50	26-36
Rear Engine Mount Lower Nut	32-47	24-34

(Continued)

**TORQUE SPECIFICATIONS (Cont'd)**

Description	N·m	Lb-Ft
RH Engine Mount Body Bracket Bolt	20-28	15-20
RH Engine Mount Body Bracket Bolt	67-91	50-67
RH Engine Mount Through Bolt	45-65	34-47
Front Engine Mount to Transmission Bolt	37-52	28-38
Front Engine Mount Nut	60-85	45-62
Rear Engine Mount Bolt	37-52	28-38
Rear Engine Mount Nut	64-89	48-66
Front Engine Mount Through Bolt	64-89	48-66

**SPECIAL SERVICE TOOLS**

Tool Number	Description
D88L-6000-A	Three Bar Engine Support